

## Android – Motorola Email Setup

1. Click on your email icon and if the Synchronize Accounts shows up press Other, or if the Account shows up enter your Molalla.net email address and password and press Manual setup.

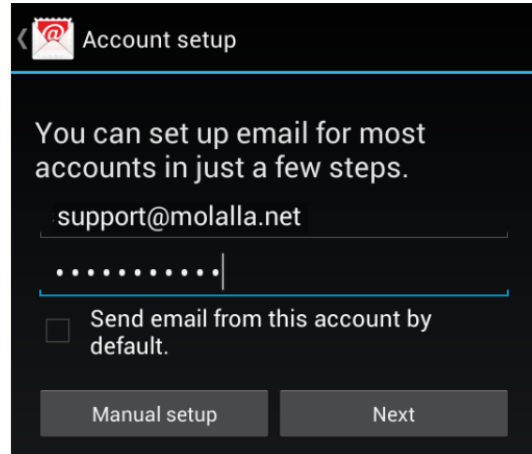

2. Select POP3 for the account type

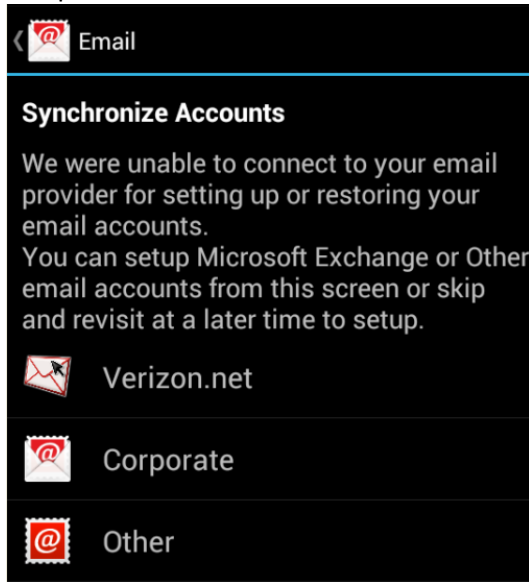
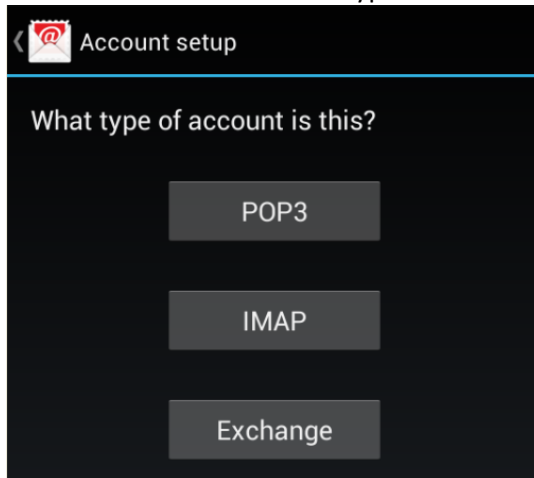

3. Enter in the following information-
  - Username – **Full molalla.net email address**
  - Password – **Your molalla.net email address password**
  - POP3 server – **pop3.molalla.net**
  - Port – **110**
  - Security type – **None**
  - Authentication method – **Auto**

Press Next

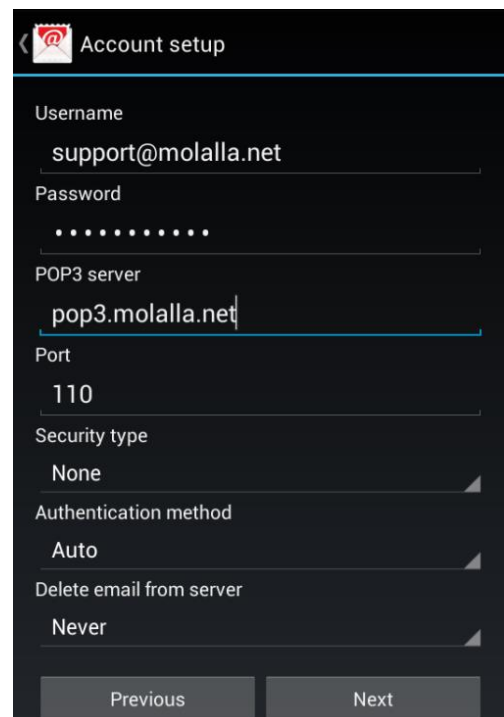

4. Enter in the following information for the Outgoing server information

- SMTP server – **smtp.molalla.net**
- Port – **25**
- Security type – **None**
- Check next to Require sign-in
- Authentication method – **Auto**
- Username – **Your full Molalla.net email address**
- Password – **Your Molalla.net email address password**

Press Next

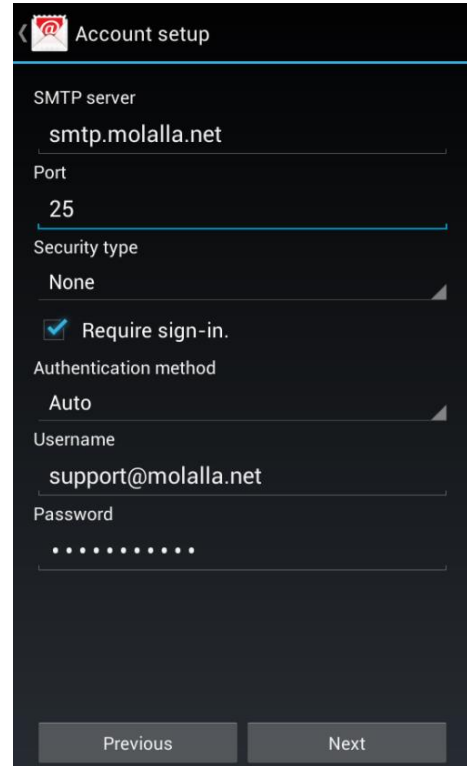

Account setup

SMTP server  
smtp.molalla.net

Port  
25

Security type  
None

Require sign-in.

Authentication method  
Auto

Username  
support@molalla.net

Password  
.....

Previous Next

5. Select if you would like to send from this email address by default, notify when email arrives, Sync email from this account etc. and press Done.

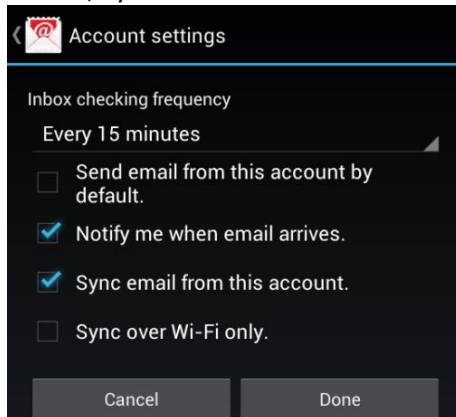

Account settings

Inbox checking frequency  
Every 15 minutes

Send email from this account by default.

Notify me when email arrives.

Sync email from this account.

Sync over Wi-Fi only.

Cancel Done

6. Enter in your name as you would like it to appear when you send emails and press Next, you should now be able to send and receive emails using your smart phone.

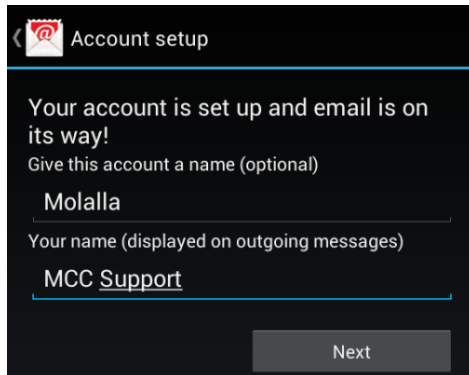

Account setup

Your account is set up and email is on its way!

Give this account a name (optional)  
Molalla

Your name (displayed on outgoing messages)  
MCC Support

Next